

## Size 10B Surface mounted hous

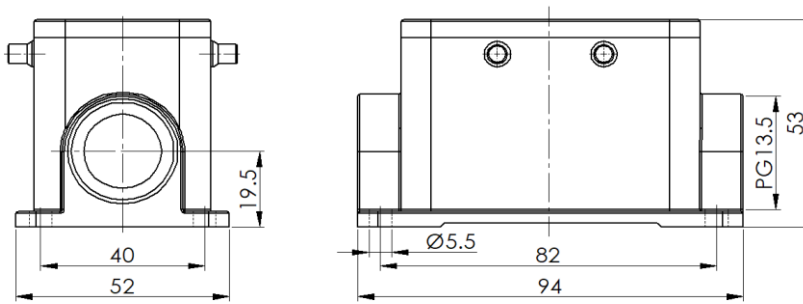

**Typecode** H10B-SM-4PR-PG13.5

**ID** 1 007 01 0000313

### Technical Data

#### Product Properties

Series	Size 10B
Mating with	HE-010, HEE-018, HDD-042
Housing type	Surface mounted hous
Cable outlets direction	Single-side opening
Cable outlets	PG13.5
Installation mode	Panel mount
Protection Class	IP65
Impact strength	IK08
Temperature range	-40 °C ... 125 °C
Standard	DIN EN 175301-801

### Features

- Die casting of aluminum
- Single-side opening
- Surface fixed installation
- NBR, black
- Resistant to salt spray
- Approval: UL94-V0
- RoHS-compliant

#### Insert

Housing material	Die-cast aluminum
Color	Gray (RAL 7037)
Seal	NBR, black

#### Commercial data

Weight	209 g
Packaging unit	1 pc
Country of origin	CN

\*The design data are listed here, and the changes to the product are not described here. For unfinished matters, please contact customer service. It is the user's responsibility to verify functionality, compliance with applicable laws and instructions, and electrical safety in specific applications.